

ପଦ୍ୟ-ସଂଗ୍ରହ



GT46/2/104

**ROAD TRAFFIC REGULATION ACT 1984 - SECTIONS 64 AND 65
AUTHORISATION OF TRAFFIC SIGNS AND SPECIAL DIRECTIONS**

The Secretary of State for Transport, in exercise of his powers under Sections 64 and 65 of the Road Traffic Regulation Act 1984, and of all other powers enabling him in that behalf, for the purpose of informing road users of match day parking restrictions in the Aston Villa Football Club stadium area, Birmingham, hereby:-

1. authorises the erection at or within 5 metres of the sites marked with a red cross on the attached schedule of plans numbered GT46/2/104(Pt2)-1 of a traffic sign (hereinafter referred to as "the authorised sign A") conforming as to size, colour and character with that shown at A on the attached drawing numbered GT46/2/104(Pt2)-2, save that the day, month and date of the next match may be varied as appropriate; and
2. authorises the erection within the black shaded areas on the said schedule of plans of a traffic sign (hereinafter referred to as "the authorised sign B") conforming as to size, colour and character with that shown at B on the said drawing, save that the days of the week and times of the day may be varied as appropriate; and
3. authorises the erection within the striped areas on the said schedule of plans of a traffic sign (hereinafter referred to as "the authorised sign C") conforming as to size, colour and character with that shown at C on the said drawing, save that the days of the week and times of the day may be varied as appropriate; and



GT46/2/104

4. authorises the erection within the grey shaded areas on the said schedule of plans of a traffic sign (hereinafter referred to as "the authorised sign D") conforming as to size, colour and character with that shown at D on the said drawing, save that (a) the days of the week and times of the day may varied as appropriate and (b) the maximum stay and "No return within" periods may be varied as appropriate; and
5. directs that the authorised signs B, C and D shall be erected in sufficient numbers to give adequate information to road users of the parking restrictions in force in the said shaded and striped areas; and
6. directs that, notwithstanding the provisions of Direction 25(1) of the Traffic Signs General Directions 2002 (Part II of SI 2002/3113, "the 2002 Directions") the authorised signs B, C and D may be used with the road marking shown in diagram 1028.4 in Schedule 6 to the Traffic Signs Regulations 2002 (Part I of SI 2002/3113, "the 2002 Regulations"), save that the word "DOCTOR" shall be omitted; and
7. directs that it is a condition of this authorisation that the authorised signs A, B, C and D may be placed only to indicate the effect of a corresponding Traffic Regulation Order; and
8. directs, without prejudice to any statutory provision to the like effect, that it is a condition of this authorisation that the erection of the authorised signs A, B, C and D at or near the said sites shall continue to have effect only until such day as may be appointed by one month's notice given by the Secretary of State in writing to the traffic authority for the removal or alteration of the authorised signs A, B, C and D and on that day the said authorisation shall, without prejudice to the giving of any further authorisation or direction, cease to have effect.



GT46/2/104

The provisions of Regulations 12, 18 and 19 of the 2002 Regulations shall apply to the authorised signs A, B, C and D in the same manner as they apply to the sign shown in diagram 661.1 in Schedule 2 to those Regulations.

Dated 12 July 2004

Signed by authority of the Secretary of State

Wemou

A Grade 7 Official of the Department for Transport





Parking Section, 4th Floor
1 Lancaster Circus Queensway
Birmingham B4 7DQ

Based upon the Ordnance Survey Mapping with the permission of the Controller of Her Majesty's Stationery Office © Crown Copyright. Unauthorised reproduction infringes A-Z and Crown Copyright and may lead to prosecution or civil proceedings.
© Reproduced by Permission of Geographers' A-Z Map Co. Birmingham City Council Licence Number LA076104/21

Permits available within the areas bounded by

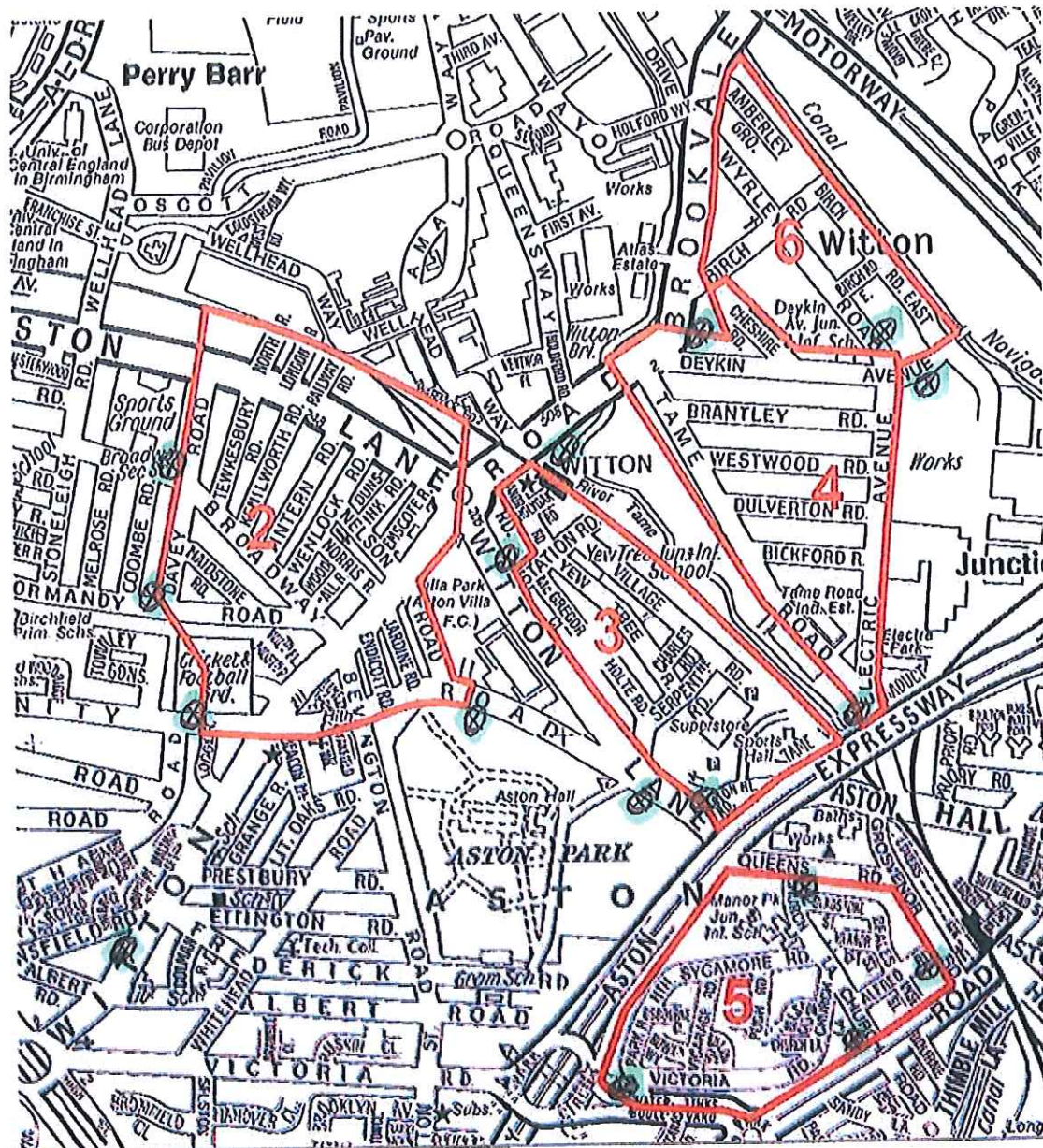

Match days only
 Resident permit holders
 Mon-Fri 6.30 - 10 pm
 Sat & Sun Noon - 6 pm

Scheme Ref.	Aston Villa Redevelopment
Sign Reference	TS2
Letter colour	BLACK
Background	WHITE
Border	BLACK
Material	Class 1
	'x'-height 20.0
	Sign FACE
	Width 355mm
	Height 415mm
	Area 0.15sq.m

Aston Villa
Match day
parking restrictions
apply
SATURDAY
DECEMBER 26

Scheme Ref.	
Sign Reference	TS4
Letter colour	BLACK
Background	WHITE
Border	BLACK
Material	Class 1
	Area 1.53sq.m
	Height 1095mm
	Width 1395mm
	Sign FACE
	'x'-height 65.0

POST(S) & FOUNDATIONS			
Mounting Number	Height	2300mm	Bases
	2		Base Width
Size	114.3x5CHS		Base Length
Length	4045mm		Base Depth
Centres	1100mm		Base Vol. o/a
illumination	No.		Earth Cover
			150mm
			Individual
			700mm
			1200mm
			600mm
			1.01 m ³

Department for Transport

Date 07.04.

W7. GT 46/2/104 (PE 2)-2

This document should not be relied on or used in circumstances other than those for which it was originally prepared and for which Mott MacDonald Ltd was commissioned. Mott MacDonald Ltd accepts no responsibility for this document to any other party other than the person by whom it was commissioned.

Mott MacDonald

Canterbury House
85 Newhall Street
Birmingham B3 1LZ
United Kingdom

Tel +44 (0)21 237 4000
Fax +44 (0)21 237 4001
Web www.mottmac.com



DAVID BULL
HEAD OF TRANSPORTATION STRATEGY

BIRMINGHAM B4 7DQ
Part of the Development Directorate of Birmingham City Council

Client:

[illegible]

Drawing No.

Notes and key to symbols

Match days only Proposed resident
only parking bays.

Mon - Fri : 5 pm - 10 pm
Sat - Sun : Noon - 6 pm

Match days only

P Resident
permit
holders

Mon - Fri
5 - 10 pm

Sat & Sun
Noon - 6 pm

Parking reserved for holders of
residents' permits.

Match days only Proposed resident
only parking bays.

Mon - Fri : 6.30 pm - 10.00 pm
Sat - Sun : Noon - 6.00 pm

Match days only

P Resident
permit
holders

Mon - Fri
6.30 - 10 pm

Sat & Sun
Noon - 6 pm

Parking reserved for holders of
residents' permits.

Match days only Parking
Spaces
Parking for 1 hour
No return within 2 hours

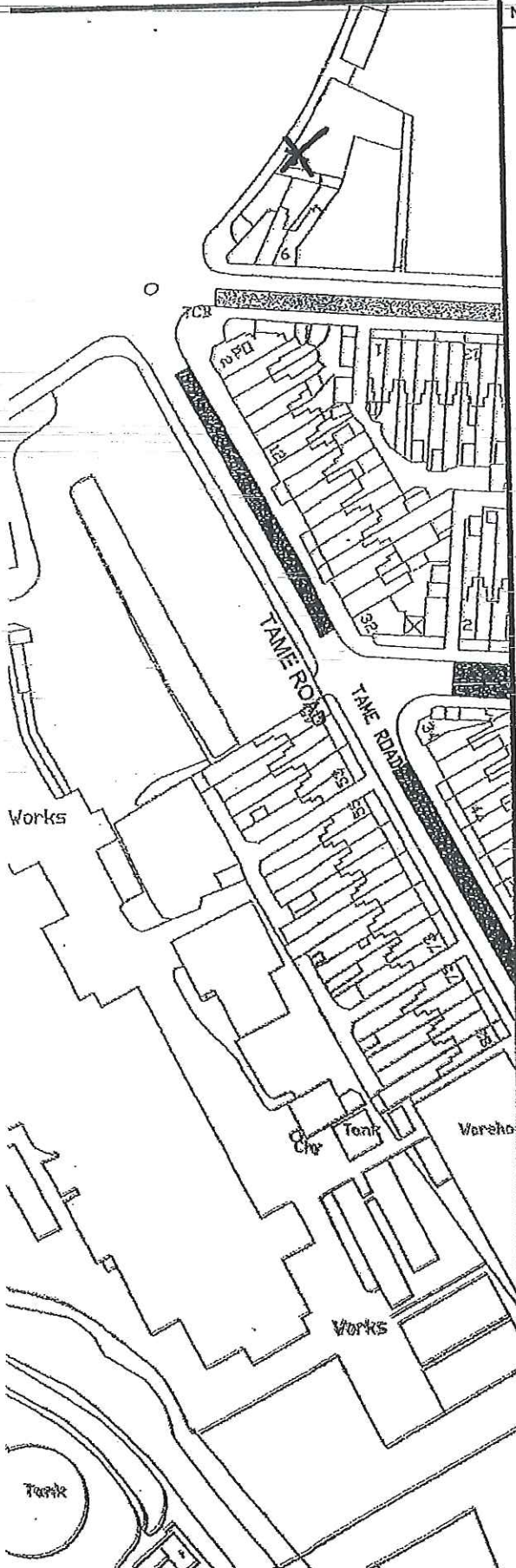

No return within 2 hours

Match days only



Mon - Fri
5 - 10 pm
Sat & Sun
Noon - 6 pm

1 hour

No return
Within 2 hours

Proposed advanced parking restriction sign locations

Aston Villa

Match day
parking restrictions
apply

SATURDAY
DECEMBER 26

Advanced Parking
Restriction Sign

Department for Transport

Date 9.7.04

No. GT 46/2/104 (P2)-1

C	June'04	RCD	For Construction		
P2	01.08.03	AS	New lamp post added		
Rev	Date	Drawn	Description	Ch'kd	App'd

m Mott MacDonald

Canterbury House
35 Newhall Street
Birmingham B3 1LZ
United Kingdom
Tel +44 (0)21 237 4000
Fax +44 (0)21 237 4001
Web www.mottmac.com

Client



Birmingham City Council
Transportation Strategy

DAVID BULL
HEAD OF TRANSPORTATION STRATEGY
1 LANCASTER CIRCUS
BIRMINGHAM B1 1QQ
Part of the Development Directorate of Birmingham City Council

The
Aston Villa Redevelopment
Residents' Parking Scheme
North West Area

Designed	S. Mirza	Eng. Chk.	S. Reeves
Drawn			

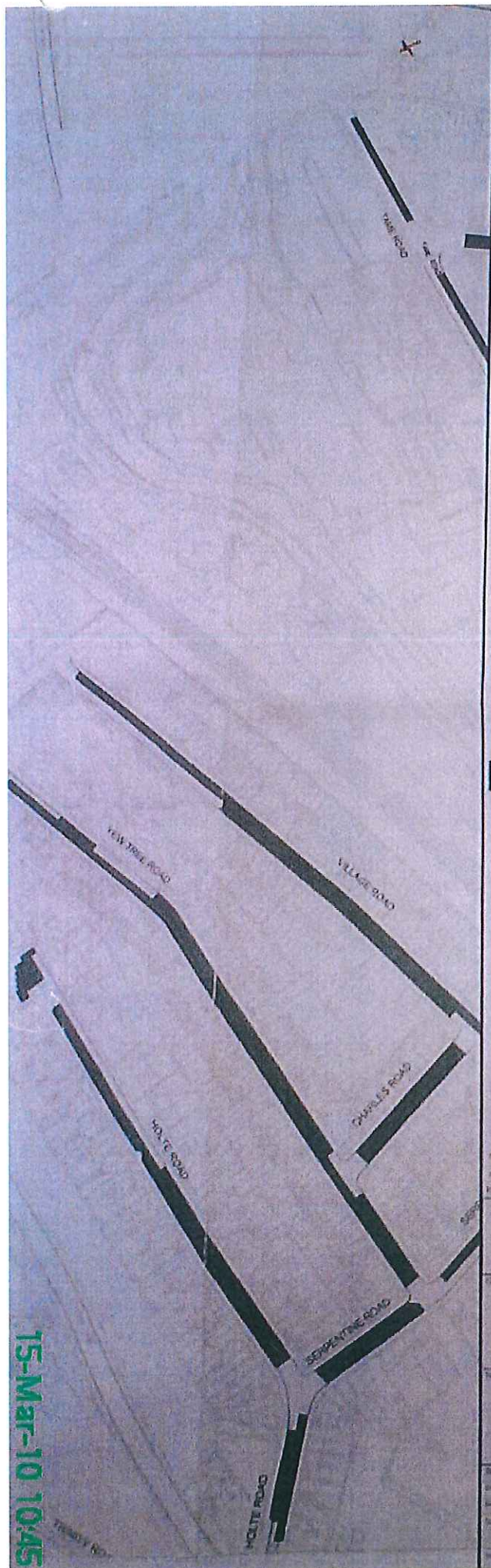

Match days only Proposed resident only parking bays

Mon - Fri 5 - 10 pm
Sat - Sun Noon - 6 pm

Match days only

P Resident permit holders
Mon - Fri 5 - 10 pm
Sat & Sun Noon - 6 pm

Parking reserved for holders of resident's permits

Match days only Proposed resident only parking bays

Mon - Fri 6.30 pm - 10 pm
Sat - Sun Noon - 6 pm

Match days only

P Resident permit holders
Mon - Fri 6.30 - 10 pm
Sat & Sun Noon - 6 pm

Parking reserved for holders of resident's permits

Match days only Parking spaces
Parking for 1 hour
No return within 2 hours

Match days only

P Mon - Fri 5 - 10 pm
Sat & Sun Noon - 6 pm
1 hour
No return Within 2 hours

Proposed proposed parking restriction sign locations

Aston Villa
Match day parking restrictions apply
SATURDAY DECEMBER 26

Advanced Parking Restriction Sign

11M Mott MacDonald

Birmingham City Council
Transportation Strategy

Aston Villa Redevelopment Residents' Parking Scheme North West Area

1:1000

PRE

15-MAR-10 10:45

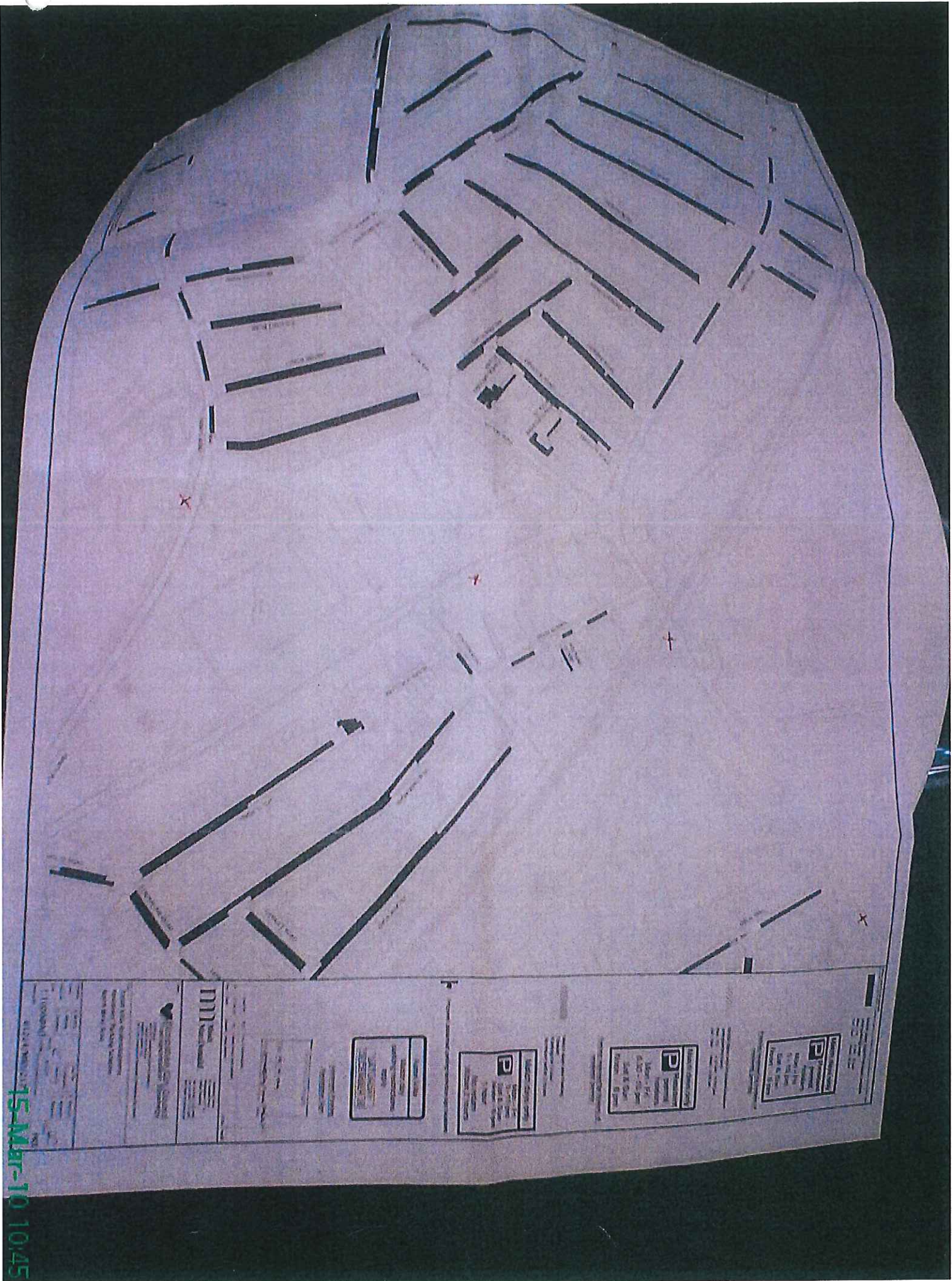

15-MAR-10 10:45

[illegible]

Model	MR22	Engine	1.600cc	1. Rating	
Year	MR22	Transmission	Automatic	2. Rating	
Body-ty	Runabout	Color	Red	3. Rating	
Size	Small	6/224		4. Rating	
1:1000 AD		PRE			